



C300.001TC, C300.10TC Stainless Steel Conductivity Sensor

INSTRUCTION MANUAL

EN 09-10

1. General data

These special sensors are particularly suitable for conductivity measurement in applications where stainless steel is requested as material in contact with fluid.

Sensors are completely sealed and consist on:

- _ a double coaxial electrodes conductivity cell,
- _ a Pt1000 temperature sensor with 3 wires connections,
- _ cable connection wires are marked by different colours.

2. Technical features

Wetted Materials :

Sensor Body: Stainless Steel AISI 316L

O-ring : EPDM

Temperature@Pressure: 100°C @ 7 bars (installed in PP fitting);
100°C @ 34 bars (installed in SS fitting);
120°C @ 13 bars (installed in SS fitting).

Cable : 3 meters of shielded cable with 5 wires

Cell constant: 0,01 ; 10,0

3. Installation

Conductivity sensor should be installed properly to gain best performances.

It should obey these rules:

- _ sample in contact with sensor should be representative of fluid to measure;
- _ liquid should continuously flow through the cell;
- _ flow rate should avoid cavitation phenomena;
- _ cell mounting should be so that an air bubbles presence is avoided on electrodes surface;
- _ solid sediments shouldn't accumulate into space between electrodes dedicated to measurement;
- _ it should verify that temperature and pressure conditions are obeyed.

4. Electrical connections

Conductivity sensor have to be connected to conductivity monitor/controller in the following way:

WHITE wire	signal
BLACK wire	signal
CLEAR wire	shouldn't be connected
RED-TC wire	should be connected to 29 position
GREEN-TC wire	should be connected to 28 position

5. Maintenance

This type of sensor doesn't require particular operations for maintenance except for the eventual cleaning of the electrodes.

Dimensional Data Table			
Model n°	"A"	"B"	"C"
C300.001TC	2"	5,25"	3,5"
C300.10TC	0,5"	9,1"	7,6"

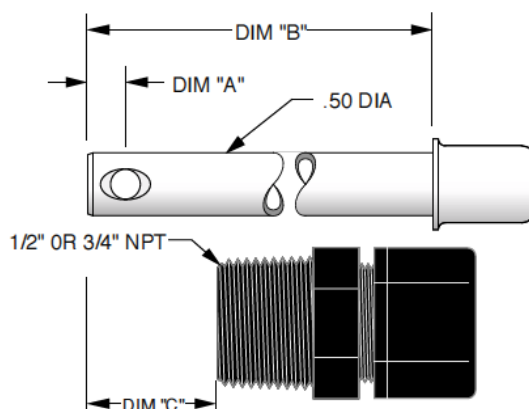

6. Installation

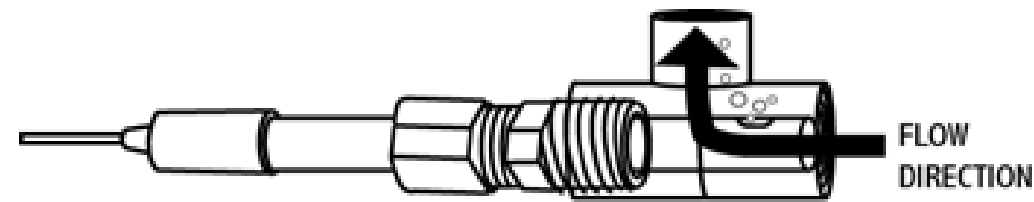

F.I.P. Formatura Iniezione Polimeri S.p.A.
 Loc. Pian di Parata, 16015 Casella (GE) – Italy
 Tel +39 010 96211 – Fax +39 010 9621209

www.flsnet.it